

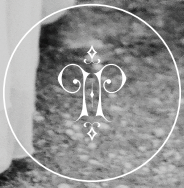

PAVILION



**ROSEWOOD PHUKET** the first Southeast Asia resort for Rosewood Hotels & Resorts®, offers a secluded island retreat and a sophisticated interpretation of the brand's A Sense of Place® philosophy, taking inspiration from the natural landscape, diverse cultures and unique sensibilities of Thailand's largest island. The Pavilion -- a residential-style events space with innovative design and picturesque views over the tropical beachfront -- offers an idyllic setting for both formal and informal meetings, functions and social events. Encompassing the Glasshouse, Courtyard, Garden and Beach Lawns, the selection of indoor and outdoor spaces are furnished and styled to capture the essence of a sophisticated beachside estate.

INDOOR MEETING SPACE

**243** SQ. M.

*(2,615 sq. ft.)*

CAN ACCOMMODATE

UP TO

**192**

GUESTS

OUTDOOR FUNCTION AREAS

**1,045** SQ. M.

*(11,248 sq. ft.)*

CAN ACCOMMODATE

UP TO

**220**

GUESTS



# CAPACITY CHART AND FLOOR PLAN

## 1 GARDEN + BEACH LAWN

<i>sqm</i> <b>875</b>	<i>size (m)</i> <b>22x40</b>	<i>height (m)</i> -				
RECEPTION 220	BANQUET 150	THEATRE -	CLASSROOM -	BOARDROOM -	HOLLOW SQUARE -	U-SHAPE -

## 2 GLASS HOUSE

<i>sqm</i> <b>243</b>	<i>size (m)</i> <b>11x22</b>	<i>height (m)</i> <b>4.65</b>				
RECEPTION 220	BANQUET 150	THEATRE 192	CLASSROOM 90	BOARDROOM 48	HOLLOW SQUARE 66	U-SHAPE 57

## 3 COURTYARD

<i>sqm</i> <b>170</b>	<i>size (m)</i> <b>20 X 20</b>	<i>height (m)</i> -				
RECEPTION 80	BANQUET 50	THEATRE -	CLASSROOM -	BOARDROOM -	HOLLOW SQUARE -	U-SHAPE -



# THE PAVILION

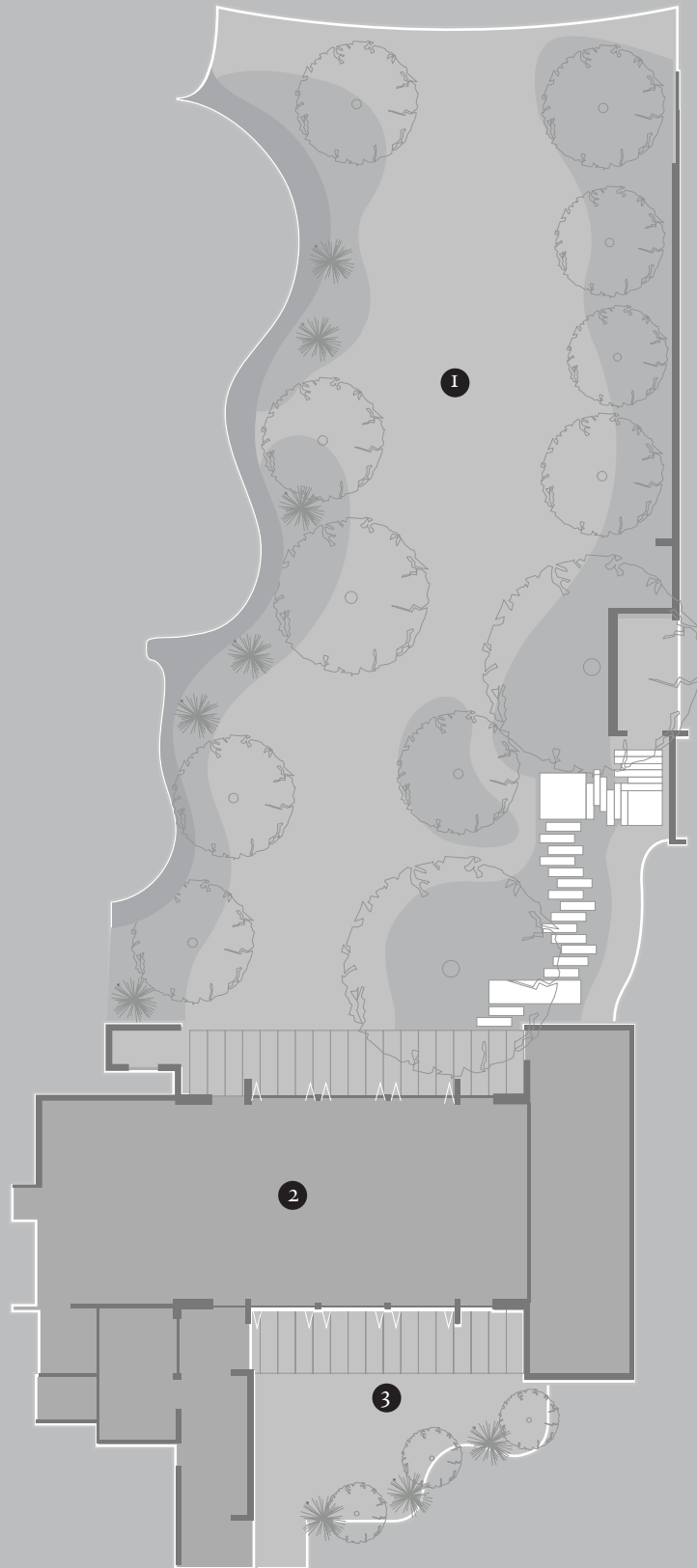

#### **LOCATION**

Situated in secluded Emerald Bay, a winding coastal road provides convenient access to a nearby bustling seaside town, while authentic experiences of the island's cultural attractions and historic Old Town are within easy reach. Serving as a gateway to the Andaman Sea, the piers and marinas of Phuket are located within a 30-minute drive of the airport.

#### **MEETINGS**

The Glasshouse, a 243 sq.m (2,615 sq. ft.) residential-style indoor venue includes a large pillar-less function space with an adjacent break-out room. The innovative architecture features high ceilings and full-length windows to allow in abundant natural light and tranquil tropical garden views.

#### **EVENTS**

Charming and refined outdoor spaces cater for a range of occasions from intimate ceremonies to larger social gatherings and receptions. The Courtyard at 170 sq. m (1,830sq. ft.) creates an exclusive and relaxed ambiance against a cascading, hillside garden backdrop. The Garden and Beach Lawns, bordered by verdant foliage and scenic walkways down to the beach, cover a total area of 875 sq. m (9,418 sq. ft.) and can accommodate up to 220 guests.

#### **SERVICE**

The meeting facilities complement a personalized service that is timely, attentive and anticipatory of guest needs, flawlessly executing every occasion. A dedicated Events Studio provides a visual showcase featuring a unique collection of fixtures and accessories for one-of-a-kind experiences. Our event specialists offer expert guidance in organizing the essential details that shape each function; from the floral arrangements and décor through to the menu choices and entertainment.

#### **CUISINE**

Our executive chef and his brigade tailor world-class gourmet experiences with exceptional service delivery that truly surprise and delight. From themed coffee breaks to extravagant gala dinners, customized menus are designed matching the event concept, featuring classical Mediterranean cuisine and Thai-inspired gastronomy with a contemporary flair.

#### **TECHNOLOGY**

The Glass House is outfitted with the latest, state-of-the-art audiovisual technology and equipment, while our skilled engineers offer professional on-site technical assistance and impeccable service to ensure a wide range of technical capabilities for each function.



